



ILLINOIS VALLEY  
**WHEELMEN**

*greater peoria's bicycle club*



December, 1999

## CHRISTMAS PARTY

Friday, December 10, 7:00 P.M.  
10214 North Forrest Drive, Peoria

Bill and Marge Semmens have volunteered to host the IVW Christmas Party. Bring your own beverage and a hors-d'oeuvre or dessert to share. We will have holiday music and festivities. See map, call 693-9388 if additional information is needed.

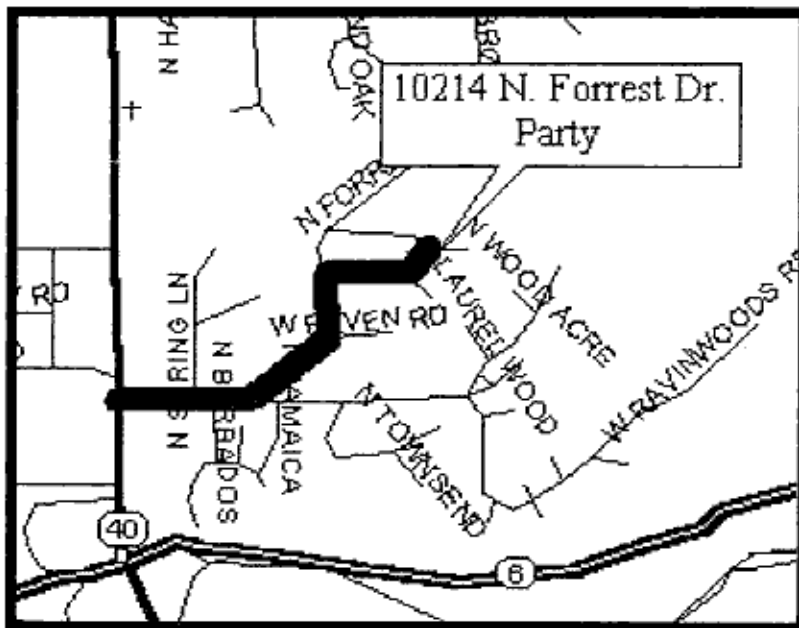

### Directions:

North on Knoxville  
Right on Ravenswood Road  
Left on Raven Road  
Take the first left, next right, next left.

### New Members

Bill & Freda Clark<sup>^</sup> ..... Washington  
Greg Durst<sup>^</sup> ..... Dunlap  
James & Jean Harvey ..... Pekin  
Norman & Amber Holmes<sup>^</sup> . Peoria  
Gene Short ..... Peoria

### Renewing Members

Ron Anderson<sup>\*^</sup> ..... Washington  
Derry & Stacey Delvecchio Dunlap  
Ron Jetton<sup>\*</sup> ..... Dunlap  
Steve Kurt<sup>^\*</sup> ..... Dunlap  
Ron & Jan Matuska<sup>^\*</sup> ... Mackinaw  
Mark & Vicki Padesky Family .....  
..... Peoria  
Thomas Parr<sup>^\*</sup> ..... Chillicothe  
Patty & Todd Sage<sup>^\*</sup> .... Chillicothe  
Marc & Carol Squillante<sup>^\*</sup> ... Peoria  
Dorothy Venturi ..... Farmington

\*LAW Member    ^Advocacy

## Metamora Rides

Sunday afternoon rides from the square in Metamora have been well attended. The ride will continue through December, if there is still interest. We have been covering between 30-35 miles at about a 15 mile per hour average. If the weather forecast calls for temperature highs below freezing, or high winds, please call to make sure the ride is still on. We leave at 1:00 P.M. from the square in Metamora. Hope to see you there! Jim and Sarah Emmons 246-2166

## Illinois Valley Wheelm'n

Greater Peoria's bicycle club

Affiliated with the League of  
American Bicyclists and League of  
Illinois Bicyclists

### President

Patty Sage 274-9145  
PSage16693@aol.com

### Vice President

Jim Emmons 246-2166

### Secretary / Treasurer

Bill and Brenda Clark 347-4841  
wdclark@mtco.com

### Ride Chairman

Bill Semmens 693-9388

### Social / Membership

Sarah Emmons 246-2166  
tandemx2@joysta.com

### Mailing

Marge Semmens 693-9388

### Database

Larry Davis 691-3060  
lardavis@worldnet.att.net

### Advocacy/Government Relations

Eric Hutchison 688-7038 (evenings,  
weekends) 578-8239 (days)  
erichutchison@juno.com

### Editor

Rob Alexander 444-3297  
robalexander@worldnet.att.net

### Webmaster

Patty Sage 274-9145  
PSage16693@aol.com

Submissions, including stories, news,  
images and/or humor are welcomed.

Deadline: 15<sup>th</sup> of the month

### IVW On The WEB

[http://www.geocities.com/  
Colosseum/Field/6055/](http://www.geocities.com/Colosseum/Field/6055/)  
*enter the above as one line, no  
spaces*

## Tuesday Rides

The Tuesday rides from Dunlap are continuing, meet at 5:00 P.M. bring your lights and enjoy the cool weather. Call Steve Kurt 243-7684.

## Quiet Hero News

The following IVW members supported the Red Cross Quiet Hero program with their blood donations during the months of July thru October:

Rob Alexander

Ron Anderson - two donations

Nancy Buzan - four pheresis donations

Joe Camp

Bill Clark - two donations

Marcia Grebner - four pheresis donations

Steve Kurt - two donations

Rich Morris - two donations

Bill Semmens

Brian White - two donations

The upcoming holiday season would be an excellant time for IVW members not presently donating to consider a gift of blood. Please call me at 444-2018 if you have any questions about the Quiet Hero program.

Thanks,

Ron Anderson,  
Quiet Hero Coordinator

## The Kellar Branch

The RTA (Recreational Trail Advocates) and the Peoria Park District are requesting our help at the Peoria City Council meeting on Dec. 21. At that time the City Council is expected to vote on the Kellar Branch Trail. This could be a nice link between the trail in downtown Peoria and the Rock Island Trail, contact Tim Beaney at the Bicycle Bus for more information.

## Annual Meeting

Approximately 30 people attended the annual meeting at Kenyon's in Lacon. A brief business meeting included annual reports. Door prizes were furnished by Russell's, Illinois Cycle, and Little Ade's.

Elections were held at the annual meeting for the following positions:

President - Patty Sage

Vice President - Jim Emmons

Social and Membership - Sara Emmons

Ride Chair - Bill Semmens

Mailing - Marge Semmens

Most Improved Female Rider - Sheila  
Gribble

Most Improved Male Rider - Larry  
Paustian

Hub of The Club - Rich Morris

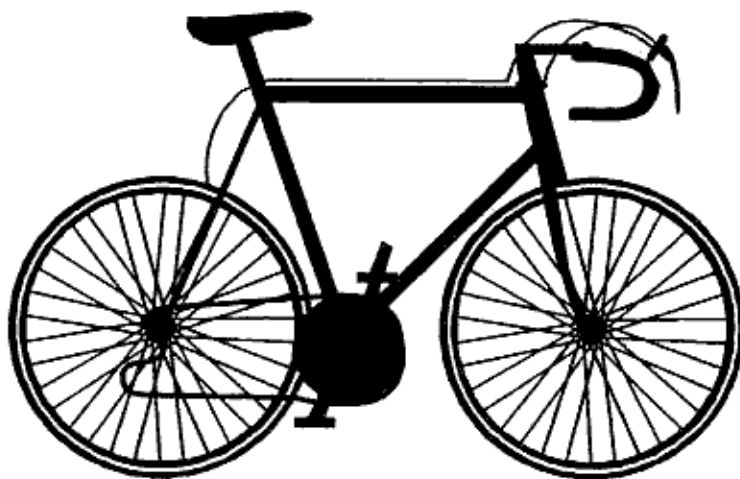

**For Sale:** 700c Front Wheel Sansin hub,  
Araya rim, 36 hole, decent shape, \$15  
Contact Steve Hueser, 263-3544,  
[hueser@dpc.net](mailto:hueser@dpc.net)

**For Sale:** Cannondale Road Frame - 56cm  
c-c (57 c-top of tt) Top tube length 55.5  
c-c, very light aluminum frame - yellow alloy  
fork and installed Shimano 600 headset  
very good condition \$70 Contact Steve  
Hueser, 263-3544, [hueser@dpc.net](mailto:hueser@dpc.net)

# LIB News

Three states: Illinois, Wisconsin and Michigan have agreed to design and purchase new trainsets that would be used to increase frequencies and reduce transit times for train service from Chicago to Madison, St. Louis and Detroit.

The design committee had their first meeting this week. I would like to improve our chances that they will include bike racks in the design. (I recently toured the trainset that they are leaning towards. It comes with very inexpensive, easy to use racks.)

Would you be kind enough to send a letter to the Governor requesting that the racks be included? If you could also fax or mail me a copy that would be very helpful. Following is a sample letter. If you have any questions, please call me at 312-339-0116.

Thanks,  
Rick Harnish  
PO Box 805878  
Chicago, IL 60680-4120

George H. Ryan  
Governor of Illinois  
207 Statehouse  
Springfield, IL 62706

Dear Governor,

Thank you for agreeing to cooperate with Wisconsin and Michigan on the design and purchase of modern trainsets for a midwest high speed rail network. Rail service is very important to the region and this is a very positive step forward. Please direct your staff to include bike racks in the design criteria of these trainsets. As you are aware, the use of bicycles for basic and recreational travel has increased dramatically recently. Bike racks onboard the train will increase rail ridership by creating an easy way to get to and from the station, and by extending the range of a bicycle trip. Thank you for your help in this matter. If I can be of any assistance, please call me at .

Sincerely

## ILLINOIS VALLEY WHEELMN MEMBERSHIP APPLICATION

Are you renewing, or is this a new membership? (check one)

Renewing  New

If new, how did you find out about the club? \_\_\_\_\_

Are you an IAB member? (check one)

Yes  No

Basic membership:

Individual (\$10) \$ \_\_\_\_\_  
Household (\$12) \$ \_\_\_\_\_

Voluntary advocacy contribution:

(\$5, 10, 15, other) \$ \_\_\_\_\_

Total enclosed \$ \_\_\_\_\_

Name #1 \_\_\_\_\_ Birthdate \_\_\_\_\_  
please print clearly

Name #2 \_\_\_\_\_ Birthdate \_\_\_\_\_

Name #3 \_\_\_\_\_ Birthdate \_\_\_\_\_

Name #4 \_\_\_\_\_ Birthdate \_\_\_\_\_

E-mail address (print clearly) \_\_\_\_\_

Address \_\_\_\_\_

City \_\_\_\_\_ State \_\_\_\_\_ ZIP \_\_\_\_\_

Phone ( ) \_\_\_\_\_

Signature (Name #1) \_\_\_\_\_ Date \_\_\_\_\_  
(parent or guardian if registrant is under 18)

DISCLAIMER: In signing this form, I understand and agree to absolve the officers and members of the Illinois Valley Wheelmn bicycle club of all blame for any injury, misadventure, harm, loss or inconvenience suffered as a result of taking part in any activity sponsored or advertised by said organization.

Make check payable to: ILLINOIS VALLEY WHEELMN, 6518 NORTH SHERIDAN RD. STE 2, PEORIA IL 61614-2933



61615-2461 14

LARRY D DAVIS  
6809 FROSTWOOD PKY A-53  
PEORIA, IL 61615-2461

SHARE THE ROAD...MEMBER TIL: 6/21/2000

Bulk Rate  
U.S. Postage  
PAID  
Permit No. 310  
Peoria, IL

ILLINOIS VALLEY WHEELM'N  
6518 NORTH SHERIDAN RD. STE 2  
PEORIA IL 61614-2933

# New Year's Day Ride

Join us for the first club ride of 2000! (Or, just join us for the food and company!) Todd & Patty Sage are the hosts for this year's ride. The ride will be at 10:00 A.M. with the meal to follow. Bring a covered dish to share. Beverages, plates, and utensils provided. The ride length and route will be adjusted for the weather but it will be an easy ride. For more info or directions, call Todd or Patty at 274-9145 or e-mail [sage@mtco.com](mailto:sage@mtco.com).

