

6518 N. Sheridan Rd.

Peoria Ill. 61614



 **ILLINOIS
VALLEY
WHEELMEN**

March 1987

Ride of the Month

3/15/1987

St. Patrick's Day Ride is the March ride of the Month. We will start from Washington Square in Washington, Il. at 1:00 p.m. for a 10-15 mile jaunt and return on IRISH LANE to WELCH'S PUB for refreshments. JOIN US!



NEED SOME EXTRA MOTIVATION TO RIDE THAT CENTURY THIS SUMMER??? Come see and hear Lon Haldeman, winner of the '82 and '83 RAAM, and Susan Notorangelo, winner of the '85 RAAM. They will be here to do an IVW special presentation on March 28, at St. Francis Hospital-700 Auditorium, 7 -9 p.m. They will bring a multimedia presentation of the RAAM, Wayne Phillips Tandem Benefit ride, plus ultramarathon cycling tips. Admission will be a goodwill offering to help defray expenses. St. Francis is donating the auditorium to us so any extra donations will be given to the Children's Miracle Network. Directions to the auditorium- go in old main entrance, take elevator to the 7th floor and follow the signs.

A lot has been happening in the wonderful world of bicycling. Many of you have seen this year's telecast of RAAM. This month you'll be able to meet two of the participant's in person. The IVW is bringing Lon Haldeman and Sue Notorangelo to Peoria. Do not miss this special program.

Lon has been here before, giving an excellent program. This one should be even better given his experiences of the past few years and the presence of Sue. Even if you have no personal interest in ultra-marathon bicycling, you will find Lon and Sue to be warm and friendly people. They both enjoy the lemonade and cookie rides as much as we do. It's not uncommon to see them on the same rides we go to throughout the Midwest. See you there!

The League of American Wheelmen has again undergone more changes. This time I whole-heartedly support those changes which include less emphasis on the use of the name BICYCLE USA, except as the title of the magazine. Other changes were the firing of the executive director and the elimination of that position. It was replaced with an administrator, who would be more responsive to the wishes of the board of directors. The responsibilities will be carried out by an administrator selected by the board. Steve Clark of Colorado was elected president of the board and we have had some correspondence. I urge you to join the League of American Wheelmen and to support its objectives.

One of the challenges to the officers of the IVW is to come up with a ride schedule that meets the needs of most of our members. Believe me, we have tried to do just that. In the near future you will see a great variety, there should be several that interest you. If not call Bob or Val Jones and volunteer to lead the ride of your choice. Some of the rides you will see include the annual Metamora VFW pancake and sausage breakfast, a progressive dinner ride, junk food ride, health food ride, ice cream ride, and the regular Saturday breakfast ride. Do we like to eat? I have heard from several members who wanted more rides on Saturday and also Sunday afternoons. But to date we have not been able to come up with a good solution. If you would like to lead a ride one of those times, or any other, let Bob and Val know. We know we can't please everyone but that doesn't mean we won't try.

May the wind be at your back

Ron 

March Meeting

CARTER LEBEAU

"THE SOCIAL CYCLIST"

MARCH 26, 1987 at SAFETYTOWN

For the MARCH Meeting Carter LeBeau, of TOGIR and RAGBRAI fame, will speak on the many facets of his cycling career. Carter has been active in bicycling for over 20 years. He has been the organizer of many successful charity bike-a-thons; century rides, and toured thousands of miles on various trips. Carter has cycled coast-to-coast and is one of only a handful of people to have ridden in all 14 RAGBRAI events. He founded TOGIR (the other great Iowa Ride) and continues to take on new challenges. BE THERE!

For the APRIL monthly meeting of the IVW we will have Rod Rogers, an area cyclist, runner and swimmer who has competed in the IRONMAN TRIATHLON in Hawaii.

WEDNESDAY EVENING RIDES

March-April Ride Schedule

WILL BEGIN ON MAY 5, 1987

PEORIA--The Peoria ride will start at Charter Oak School at 6:00p.m. Join us after the ride for refreshments at Avanti's on Sterling.

WASHINGTON--The Washington ride on Wednesday will start from the square at 6:30p.m.

SATURDAY MORNING RIDE

This ride is for all types of bikers from the Novice to the Racer. We start from Washington Square at 8:30 a.m. and usually travel to a nearby town for breakfast. The length is usually around 25-30 miles. We will try to have both a leader and a "sweep" on these rides so the slower riders should not hesitate to attend these very enjoyable Saturday Morning affairs.

SUNDAY MORNING RIDES

3/8/87 BRIMFIELD AMERICAN LEGION HALL IN BRIMFIELD, IL. 8:30 a.m.

3/15/87 * RIDE OF THE MONTH FOR MARCH ST. PATRICKS DAY RIDE
Meet at Washington square, 1:00p.m. for a 10-15 mile ride coming back on IRISH LANE. Refreshments after at Welch's Pub on the square.

3/22/87 COUNTRY BUFFET--EVERGREEN SQUARE, PEORIA, IL. 8:30 a.m.

3/29/87 PEORIA COURTHOUSE TO MORTON 20 miles, then breakfast at McDonalds. 8:30a.m.

4/5/87 * APRIL RIDE OF THE MONTH THE ANNUAL SPRING BREAK-OUT RIDE
Washington square to Metamora. 25 mile easy ride to the American Legion for all you can eat Pancakes & Sausage. 8:30 a.m. Jack Welch, Leader

4/12/87 PALM SUNDAY RIDE 8:30 a.m.
Start at Field Shopping center in Morton, Il. and ride to Mackinaw. 20-25 miles Bob Jones, Leader

4/19/87 EASTER SUNDAY RIDE *****1:00p.m. *****
Start at Glen Oak Conservatory in Peoria for a 15-20 mile tour of the city. Sam Joslin, Leader NOTE START TIME OF 1:00 p.m.

4/26/87 PEORIA COURTHOUSE TO WASHINGTON, ILL. 8:30 a.m.
Will ride to Washington Family Restaurant--25-30 miles--Bill & Julie, Leaders.

NEXT REGULAR MEETING -- March 26, 1987 7:30 p.m. Safteytown

Meetings

Carter LeBeau of R.A.G.B.R.A.I. AND T.O.G.I.R. fame will speak on his career in cycling

NEXT IVW BOARD MEETING--Mar. 22, 1987, 3:00p.m. Dean Grethey's, 2302 Sheridan, Pekin, Il.

LON HALDEMAN and SUSAN NOTORANGELO-HALDEMAN will be here for a SPECIAL PRESENTATION on March 28th at St. Francis Hospital-700 Auditorium from 7:00 to 9:00 p.m. They will talk about RAAM, the Wayne Phillips Benefit ride, plus Ultramarathon cycling tips and more.

NOTICE! NOTICE! We need ride leader volunteers or people who want to sponsor a ride. Contact Bob or Val Jones at 676-0166 if interested.

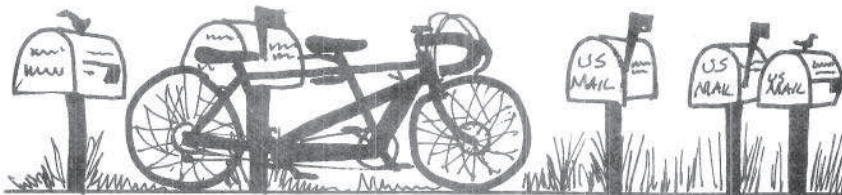

From the Mailbox

- RAGBRAI XV REGISTERS ANNUAL GREAT BICYCLE RIDE ACROSS IOWA JULY 19-25, 1987
- TOMRV TOUR OF THE MISSISSIPPI RIVER VALLEY JUNE 13-14, 1987
- TOKRV TOUR OF THE KICKAPOO RIVER VALLEY MAY 23-25
 Southwest Wisconsin's 11th Annual ride sponsored by the Chicago Chapter of AYH has 3 days of riding (82-64-67 mile segments). \$50.00 fee
 Contact; Carl Sand, Box 267, Fox Lake, Il. 60020
- RIDE TO THE RIVER Macomb Bicycle Club June 6-7, 1987
 130 mile round trip to Nauvoo, Il. \$7.50 to Bruce Meyers
 (309-833-5153) *this is same weekend as our Pedal-In

Any IVW member who needs information on any of the out-of-town rides the club hears of can obtain information at Vitesse Cycle Shop in Peoria, Hts. Il.

HILLY 100 The annual HILLY 100 in Bloomington, Ind. has set the dates of Oct. 17-18. The IVW has reserved a block of rooms at a Bloomington Hotel (Hampton Inn) for interested riders. If you'd like to go on a super hilly ride make plans for this one, we always have a large group going.



1987 IOWA BICYCLE RIDES

1987 IOWA BICYCLE RIDES

Jan. 23-24	Blue Glacier Ride, 15-25 mi
Feb. 7	BRR Bike Ride to Rippey, 23 mi. Perry
Apr. 25-26	GRBR and TOSCF, 120-150 mi, Charles City
May 1-3	Spring Reflections Ride, 125 mi
May 9	Marshmallo, Ride Around Marshall County
May 16-17	MS-150, for Multiple Sclerosis, 150 mi, Des Moines
May 17	LSSFFR, 15 and 25 mi
May 23	Mystic 50, Mystic
May 23-24	MITTU III, Newton to Amana
May 30	Jaarsma Raid, 60 mi, Newton to Pella
May 31	Spring Century, 50 or 100 mi, Cedar Rapids
June 6	"My Waterloo Days" ride, Waterloo
June 13	Volga Tour

June 13-14	TOMRV XX, Davenport to Dubuque	Aug. 14	Cherokee Fun Ride II, 17, 23 or 32 mi, Cherokee
June 20	QCBC Double Century, Davenport	Aug. 15	Bob McGehee Memorial Ride, 25 or 50 mi, Boone
June 20	Chariton Classic, 60 mi, Chariton	Aug. 15-16	Backbone Park Overnight Tour, Waterloo
June 20-26	TOGIR VI, Davenport	Aug. 16	50th Anniversary Bike Ride, Spirit Lake
June 20-27	TRAI, Tandem Ride Across Iowa	Sept. 6	Swine Trek, 25, 62 or 200 mi, Cedar Rapids
June 21	Ride the River III, Davenport	Sept. 7	DMCC Century, Des Moines
June 27-28	CIBR, Central Iowa Bike Ride, Des Moines	Sept. 12	QCBC Century, Davenport
June 28	Little Sioux Spoke Quarter and Half Century	Sept. 13	DBC Century, Dubuque
July 4	Fourth Annual "Stein Ride and Glide," Waterloo	Sept. 19	IVBC Century, Marshalltown
July 4	Amana Breakfast Ride, 55 mi, Iowa City	Sept. 20	BIC Century, Iowa City
July 11	"Get Ready" Century, Waterloo	Sept. 27	Melon City BC Century, 50, 100 mi, Muscatine
July 11	BRAWCO, 25, 50, 100 mi, Indianola	Oct. 3	Clarence Pickard Memorial Ride, 25, 50, 100 mi, Indianola
July 11-12	LION III, Decorah	Oct. 4	Kolache Run, Tour of Tama County, 85 or 100 mi, Dysart
July 11-12	Bill's Bike Ride to Winona Pettis Gate	Oct. 9-11	PILLAR, Pike Lake Leisure Autumn Ride, 120 mi
July 19-25	RAGBRAI, Iowa	Oct. 10-11	NATREX III, Waterloo
July 26-31	Winborn II, 250 mi	Oct. 11	Leaf Lookers Metric Century, Decorah
July 31-Aug. 2	BEAR II, Pella		
Aug. 8	Watermelon Metric and Double Metric Century, Marshalltown		
Aug. 8-9	TIGER IV, Eldridge		
Aug. 8-15	Experience Wisconsin, 250-300 mi		

For information on any or all of these rides send a self-addressed stamped envelope and 2 stamps to: League of Iowa Bicyclists, P.O. Box 2190, Des Moines, Iowa 50310. Please inform us of other rides.

For Sale!! Have you always dreamed about taking a long bike trip? Have you dreamed about spinning freely to new places, new adventures? Maybe all it will take for you to embark upon your own trip is to read about someone else's trip. You can do that by immersing yourself in Spinning A Dream: A Bicycle Trip Across the United States, by Laura M. Failla. The book is a journal of the author's trip from San Diego, California to Auburn, Massachusetts during the summer of 1986. In addition to being a great adventure story, the 140 page book includes 35 pages of appendices covering resources needed to plan bike trips, annotated descriptions of what to bring, and a route itinerary of the trip. The book can be purchased by sending \$7.00 (plus \$1.00 for postage and handling) for each book to: Laura M. Failla, 4064 Mississippi Street, San Diego, CA 92104.

JUBILEE-PRINCEVILLE LOOP

25.2 MILES

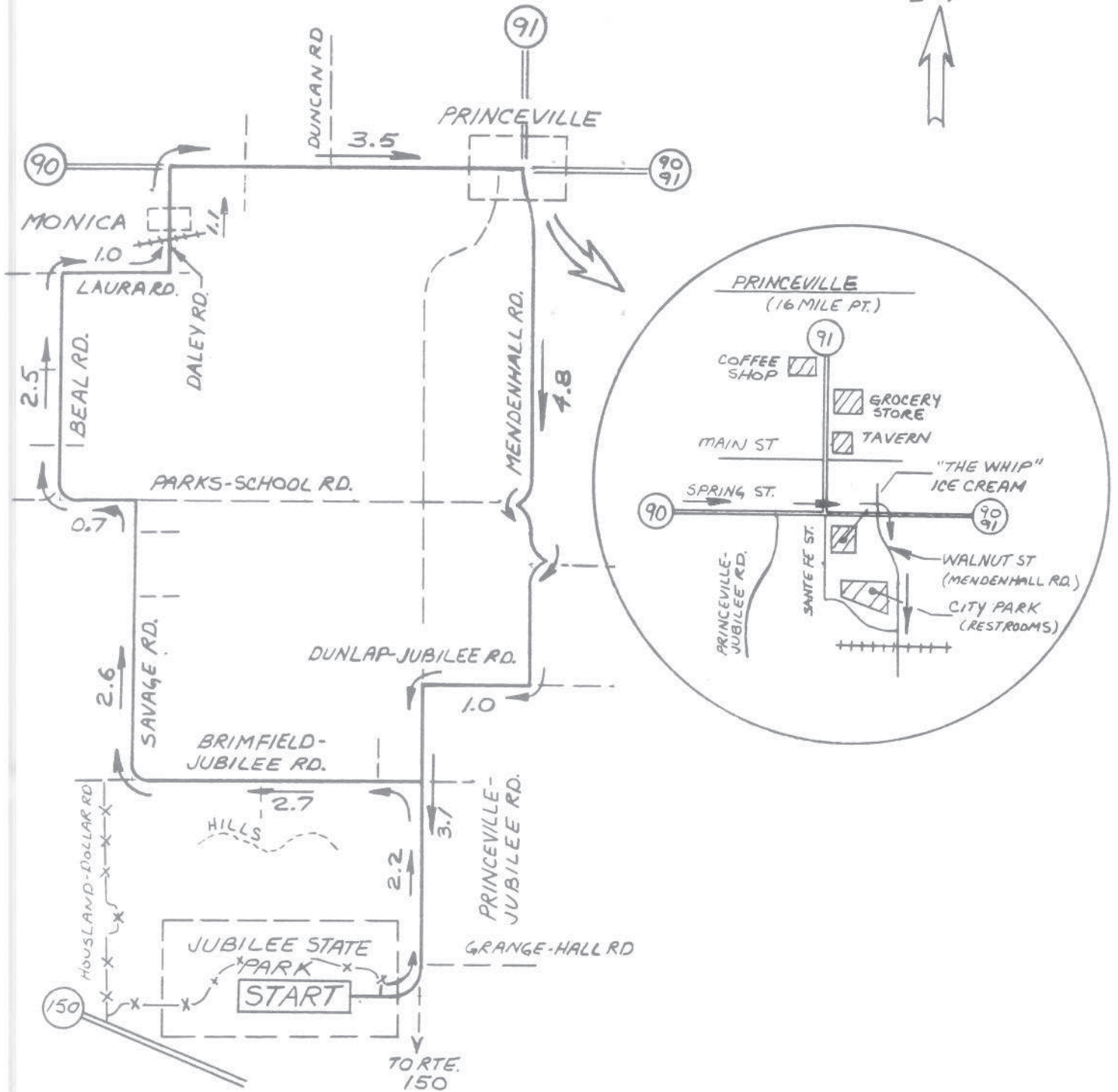

— x — x — ALTERNATE ROUTE (GRAVEL)



!!! BELIEVE IT OR NOT !!!

THERE IS TWO-WHEELED LIFE IN CENTRAL ILLINOIS BEYOND
GRANGE HALL ROAD.

Yes folks, popular rumor has it that there are, in fact, paved, lightly traveled, and scenic (yes, I said scenic) bicycling routes hidden right here in our midst. I am interested in compiling a series of favorite IVW bicycling route maps. These maps will be published in the newsletter (see the enclosed first entry) and printed in mass to be sold at local bike shops. I see these maps serving several significant needs:

- * Acquaint bicyclists new to the area with good routes.
- * Share the news of good touring routes among bicycling veterans in the area.
- * Give IVW ride leaders (especially potential ones) some basic guides to work with.
- * Enhance local interest in bicycling as legitimate and enjoyable recreation.
- * A visibility and fund raiser for the IVW.

Now the pitch...

Who better should know of the local gems of two-wheeled-touring-tranquility than the members of our favorite local bike club? Here's the basic map ingredients I feel are important:

- * Starting locations within 2 hour drive of Peoria (At least for the first maps).
- * Interesting things to see and places to "refuel". (The second best thing about biking is eating.)
- * I'm not just interested in rural routes. If you know of good (or fairly good) in-town routes, let's hear them.

Please contact me with your ideas. You don't need to prepare a full-blown map (although I won't turn it down). A sketch or even a phone conversation will do. (Don't be afraid of my answering machine. It won't bite.....to hard.)

Thanks Eric Hutchison, 3808 N. Ashton St., Peoria, Il. 61614

JUBILEE PRINCEVILLE LOOP

25.2 MILES

The starting point for this route is Jubilee College State Park (14 miles NW of Peoria off Route 150 309/243-5441). This park is a featured turning point of many IVW evening rides. The park not only has the basic bicyclists' necessities (water/restrooms/parking) but also features camping, picnicking, or for the part time hoofed cyclist, equestrian trails. An Olde English Faire featuring medieval music, warriors, and craftsmen is held at the park in June. The alternate route through the park (--x--x--) has some mud and gravel but is very scenic (ideal for mountain bikers). This road meets the entrance to the park to the east of the parking lots.

Several intersections on the route are unmarked so watch your odometer or count cross streets. Beware of the "S" intersections of MENDENHALL ROAD and PARKS-SCHOOL ROAD. The jog off of parks-school is easy to miss.

Princeville is a comfortable little town to stretch the legs and refuel. (The Buster Bars at The Whip come highly recommended.)

UN TOUR DES FEMMES

Sunday, 14 June 1987 (Rain or Shine)

Normal, Illinois

A 45 and 65 mile scenic tour for women only over the gently rolling hills of Central Illinois. Well marked routes travel over quiet country roads around lakes and through wooded valleys and farmland. Maps, catered food stops, sag service, and commemorative souvenirs included.

Dale J. Kruse

SASE to:

c/o McLean County Wheelers

100 North Linden Street

Normal, Illinois 61761



★★ BICYCLE USA ★★

The national organization of bicyclists since 1880

Introductory Savings

Join now and receive a Free Almanac

★ BICYCLE USA operates the only national legislative program that defends your right to the road, provides the only nationwide course in effective cycling, offers the most complete network of Hospitality Homes for touring bicyclists, and sponsors the annual BICYCLE USA National Rally and GEAR.

★ Our membership magazine, BICYCLE USA, has the biggest calendar of events and the best feature articles and departments. Besides our regular issues, members receive the BICYCLE USA TourFinder, and the Race Across America Official Program.

★ BICYCLE USA Almanac—your guide to everything about bicycling: clubs, rallies, books, magazines, organizations, events, dealers, and many sources of help and information. It's available only to BICYCLE USA members.

SIGN ME UP! I want to join BICYCLE USA today!

Name _____ Phone _____

Address _____

City _____ State _____ Zip _____

Individual annual membership \$18 introductory rate

Family annual membership \$22 introductory rate
(outside North America, add \$5)

Make check payable and mail to: BICYCLE USA, Suite 209 NA, 6707
Whitestone Road, Baltimore, MD 21207.

Allow 6-8 weeks for receipt of FREE Almanac and first magazine. Offer
good through December 31, 1987.

Racer Report

March is here and most of the racing team is eagerly looking forward to the start of the season. There are races in Louisville and a three race series starting in Aurora. Next month I should have some results to report as several of the team members are primed and ready to go.

One hardship that racers and tourists have in common is our barking friend the canine bicycle chaser. On a recent training ride to Roanoke, Eric Carlson collided with a white German Shepherd show dog. Eric stayed upright and we continued on until someone had a flat and we stopped to fix it. An inspection of Eric's bike showed a bent top tube, down tube, and fork. Eric contacted the dog's owner and found out that the dog had suffered a broken shoulder and leg and had undergone surgery to repair it. The owners have agreed to buy Eric a new frame, so that shows that there are conscientious dog owners in this world.

Randy Senneff and Brett Rickett have had their share of dog trouble north of Dunlap on evening training rides and on a recent Sat. A.M. ride, Mo Kelly and Peggy Tresenriter both hit the same dog while riding home from Mackinaw. Neither person fell or suffered any bike damage, nor did they slow down to check on the dog's condition!

I urge anyone having a severe problem with a particular dog to contact their County Animal Control Unit. There are laws holding owners responsible for their dog's actions. I was bitten in 1983 and broke a pump extricating the dog from my leg. I contacted the Tazewell County Animal Control Board and they handled everything. I was reimbursed for my pump by the owners and received a nice note of apology.

Well, enough dog stories, let's go for a ride!

Denny Tresenriter

From the Editor

A note about the NEW MEMBERSHIP POLICY.

1. If you have not renewed your membership since December of 1986, you will need to before April 1st. At that time we will be cutting off mailing newsletters for the 1987 season. (to non-members)
2. When you renew or join initially you will receive a full 12 months of membership. The expiration date of your membership will be on the label of your newsletter. If you have any questions or disagree with your expiration date please contact the membership chairperson. We hope this new system works well for everyone.
3. Membership applications and renewals should be sent to: Wm. Overbey, 6415 N. Imperial Dr. Peoria, Il. 61614 Please make all checks payable to the Ill. Valley Wheelmen.
4. We will not be mailing out rosters for the members this yr. If you desire a current roster, they will be available at monthly meetings and by sending a SASE to; Dean Grethey, 2302 Sheridan Rd., Pekin, Il. 61554
5. New members should be receiving a packet containing the constitution, bylaws, a patch, milage log and should be getting newsletters each month (we try to mail the newsletter out by the 8th, so you should be receiving them a day or two later). If you fail to receive the packet or you newsletter, contact D. Grethey.

UPCOMING DATES FOR YOUR IVW RIDE CALENDER

PEDAL ROUND PEORIA TOWN (Pedal-In) Sat. & Sun. June 6-7 More to come later!

DIANE'S RIDE (NOTICE!) Date has been changed to AUGUST 30, 1987

A letter sent to the Illinois Department of Transportation is included in this newsletter. This letter was sent to the IDOT in support of a similiar letter from the friends of the Rock Island Trail. There has been no response as of the end of February. Are you interested in better quality roads? Encourage others and write to the IDOT to respond to the letter of the 13th. Road design is important! Write:

District Engineer Jack Harland
Illinois Department of Transportation
6035 N. Knoxville Avenue
Peoria, Il. 61614

**RENEW
YOUR
MEMBERSHIP
TODAY!**

ILLINOIS VALLEY WHEELMEN "IVY DOUBLE EWE" T-SHIRTS

SHORT SLEEVE	(white, beige, lt. blue, gold, scarlet, kelly green, royal blue, grey, pink, yellow or lavender)	Sizes: S,M,L,XL	\$7.00
LONG SLEEVE	(All of above colors except: pink, yellow and lavender)	Sizes: S,M,L,XL	\$9.00

Deadline for ordering is May 1, 1987

NAME _____ ADDRESS _____ ZIP _____

SHORT SLEEVE QUANTITY _____ COLOR _____ SIZE _____ @ \$7.00 = _____

LONG SLEEVE QUANTITY _____ COLOR _____ SIZE _____ @ \$9.00 = _____

**Make check payable to Ill. Valley Wheelmen and send to: 6815 N. Sheridan, Peoria, IL 61614

District Engineer Jack Harland
Illinois Department of Transportation
6035 N. Knoxville Avenue
Peoria, IL 61614

Re: Rock Island Trail State Park

Dear Sir,

I am writing on behalf of 220 members of the Illinois Valley Wheelmen a 17 year-old bicycle club headquartered in Peoria; and future bicycle users of the Rock Island Trail.

Scheduled to open in late 1987, the Rock Island Trail from Alta to Princeville will be the most popular cycling attraction in Central Illinois. It is expected that many cyclists will be riding to the trailhead at Alta from Peoria. Planning is needed now to assure roads leading to the trailhead are adequate for traffic use.

The problems I will describe are not new ones, but they are bound to become critical when the trail is open. Moreover, these are not problems unique to northern Peoria, but exist throughout the district. In a nutshell:

- 1) inadequate lane width (ex. Rt. 88 north of Alta Rd.)
- 2) inoperative traffic signals (ex. Knoxville at Pioneer Parkway)
- 3) dangerous grating design (ex. Allen Rd. overpass at I-474)

Bicycle planning does not mean that expensive, and unnecessary bike lanes are built throughout the city. Good planning means that the bicycle - a road-using vehicle covered under the traffic code - is taken into account when construction is planned or when necessary to upgrade existing roads.

A good example of road design from the IDOT that greatly aided the cyclist is the Rt. 8 improvement. Resurfacing alone transformed a marginal road into an excellent entrance or exit for cyclists to Peoria.

The roads to Alta also need improvement. Imagine a cyclist from any of the subdivisions lining Rt. 88 trying to reach Alta Rd. The road is almost too narrow for existing car traffic, let alone bicyclists as well.

If a Peoria cyclist approaches nearly any traffic signal leading to the trailhead, he is likely to be held up by a metal sensing device that is unable to detect the vehicle. John Forester, a California highway engineer, proposes a simple solution - I would like your reaction to the enclosed article.

The drainage grates on Allen Rd. are dangerous parallel slots, the bicycle equivalent to an unmarked open trench. One of our members was injured by such a grate in Germantown two years ago. These grates need modification or replacement. During the summer, 30 to 50 IVW members regularly cycle past this dangerous grating to reach roads north of the bypass. When the trail is opened, this grating becomes a hazard to all the new cyclists attracted by the trail.

More and more cyclists are using Peoria roads each year. It is right and legal for them to do so. The IDOT needs to include the bicycle in overall transportation facility design and recognize the bicycle (as the courts do) as a vehicle with rights of movement on properly designed public right of ways.

I realize problems are described in a broad manner in this letter. I apologize in advance for perhaps describing problems not of your jurisdiction. I intend this letter as an introduction to some of the problems Peoria cyclists face each day.

I understand you have already received a letter from the Friends of the Rock Island Trail describing the same problems. Both of our groups are eager to have our representatives meet with you to flesh out solutions to these problems.

I look forward to your response.

Thank you,

Samuel W. Joslin
member, Illinois Valley Wheelmen

Sam sez

Pat Westefer is the IVW representative to the Friends of the Rock Island Trail. A resident of Wyoming, IL. Pat will be reporting back to us on the trail's status. He will also present IVW members concerns to the board. Be sure to attend monthly meetings to present your ideas.

The McLean County Wheelers and Vitesse have several invitational events this year including the Spring Metric on May 17th; Tour des Femmes (specifically for women) June 14th; PACRACC, the three day Labor Day weekend tour of McLean County, and an ATB, & USCF cyclocross race toward the end of October.

Charles Ruppman has set up a meeting with Peoria Police Chief Allen Andrews to discuss the current bicycle code (unchanged since 1958) and enforcement of traffic law (or lack thereof) as pertains to bicycles. What do you want Andrews to hear? Let us know -- call 682-8777. Your voice can be heard.

February's general meeting on bicycle safety was well attended. Thanks go to Dean Grethey for the slides following the movie. As you attend the group rides this year, remember to follow the basic group rules-- ride no more than double file; pull completely off the road at intersections when stopping to rest; signal your intentions to others. Before, during and after the ride -- Remember to pass along an encouraging word to newcomers -- you were in their place once.

Time trials are coming Saturday April 4th. The ten mile rides against the clock are open to any IVW member and start at the Caterpillar Mossville plant. If you plan to drive to the start, use the visitor's parking lot on Old Galena Road. Allow time to warm up before the 7 a.m. start. As in the past results will be posted monthly in this newsletter. Volunteers are needed to help with timing and turn-around duties. Call Sam at 682-8777 to volunteer and for more information.

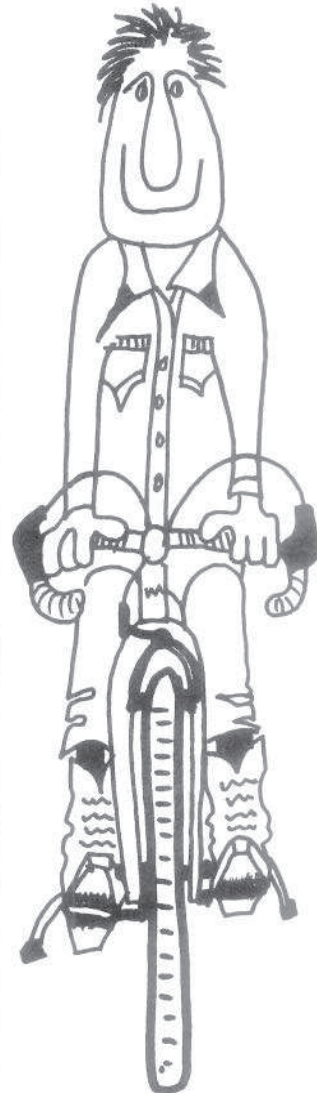

1987 ILLINOIS VALLEY WHEELMEN MEMBERSHIP

DATE _____ NAME(S) _____

NEW _____ STREET _____

RENEWAL _____ CITY _____ STATE _____ ZIP _____

DUES: \$10/INDIVIDUAL, TELEPHONE _____
\$12/FAMILY

Please make check payable to Illinois Valley Wheelmen and mail to:

William Overbey, 6415 N. Imperial Dr., Peoria, ILL. 61614



SPRINGTIME IS BIKENTIME!

The ILLINOIS VALLEY WHEELMEN is an incorporated non-profit organization of more than 20 but less than 300 members in the tri-county area.

Newsletters are distributed about 11 times a year through bulk third class mail. This won't be forwarded, so please notify the membership people if you change abodes.

- PRESIDENT: Ron Matuska 697-9009
- VICE PRESIDENT: Jean Waycuilis 699-1089
- SECRETARY: Marty Trumpold 685-4571
- TREASURER: Bill Semmens 685-9452
- RIDE CHAIRPERSONS: Bob & Val Jones 676-0166
- SOCIAL CHAIR: Nancy Beckler 686-2569
- MEMBERSHIP: Wm. & Mary Overbey 691-0040
- NEWSLETTER: Dean Grethey 346-0645
- PROGRAM CHAIR: Nickie Smith 274-2005
- EX OFFICIO Samuel Joslin 682-8777

Illinois Valley 
Wheelmen

6518 n. Sheridan Rd. - Peoria, IL 61614

19

D

Bulk Rate
U.S. Postage
PAID
Permit No. 310
Peoria, IL 61601

Ron Anderson
& Family
203 Locust
Washington IL 61571

Last
Month
12/86

RENEW YOUR MEMBERSHIP TODAY!